

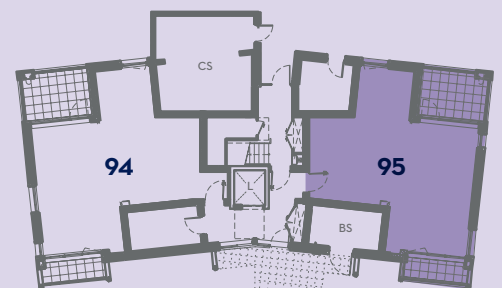

Kitchen/Dining Room	4.15m x 2.95m	13'6" x 9'7"
Living Room	3.35m x 3.55m	11'0" x 11'6"
Bedroom	2.80m x 3.45m	9'2" x 11'3"



GROUND FLOOR

► Measuring points    ST - Storage    W - Wardrobe    W/M - Washing Machine    L - lift    BS - Bin Store    CS - Cycle Store

Floor plans shown are approximate measurements only. Exact layouts and sizes may vary. All measurements may vary within a tolerance of \*50mm and are not intended to be used for carpet sizes, appliance sizes or items of furniture. Furniture layouts are indicative only. Kitchen layouts are indicative only, please ask one of our sales executives for further information.